

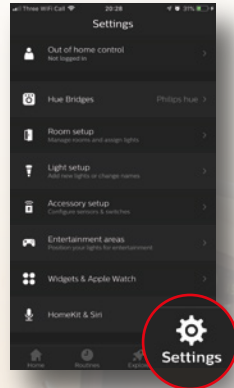

Zigbee Smart Plug

Instructions for pairing with Philips Hue Bridge

1 Open the Hue App and press Settings.



2 Select Light setup and then select "Add Lights"

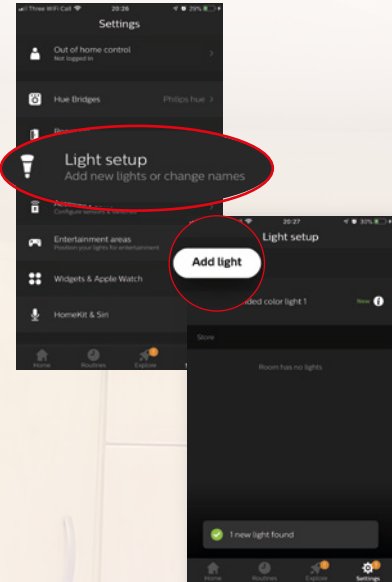

3 Select "Search". Press and hold the POWER BUTTON on the Smart Plug for 5 secs. Once the LED starts flashing you can then let go of the button.

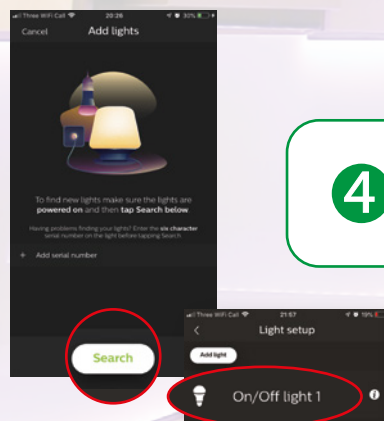

4 Add to room via room setup

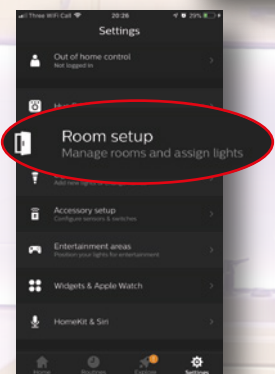

5 Now create a room or add the newly discovered light to existing room*

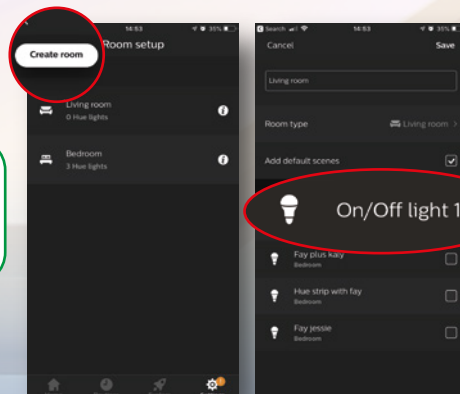

***NOTE:** If the device was paired with a ZigBee hub before, you will need to hold the button of the Smart Plug for 10 seconds to reset the Smart Plug. The indicator will blink rapidly if successful.

Zigbee Smart Plug

Instructions for pairing with SmartThings Hub

1 Assuming you have your SmartThings hub installed and setup. In the SmartThings app, press "+"

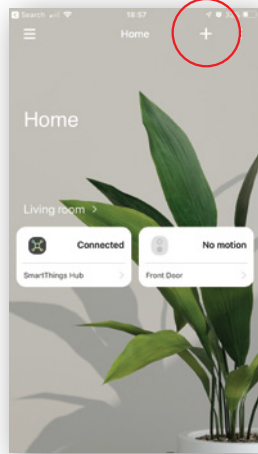

2 Now click on SmartThings under "All brands"

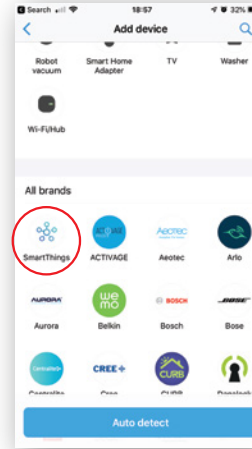

3 Select "Outlets"

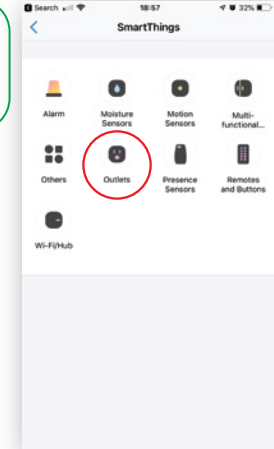

4 Select "SmartThings (STS-OUT & Others)" and then select "Next"

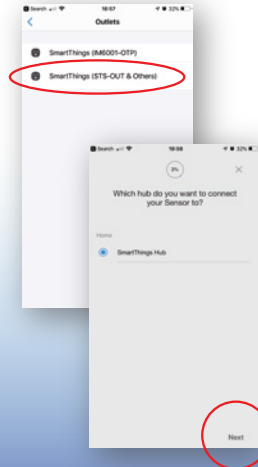

5 Now select "Continue" and then "Next"

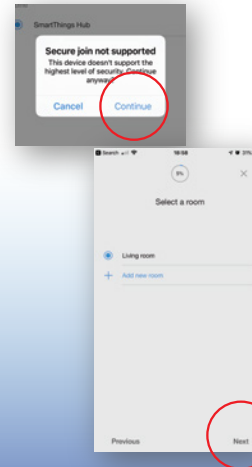

6 Now Press and hold the power button on the plug for 5 secs. The light will go from light green to a solid dark green. Letting go of the button will make the light flash.

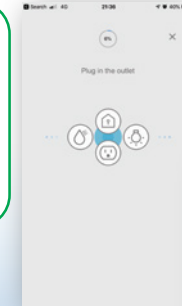

7 Your device will appear as "Thing".

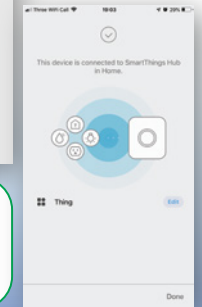



Zigbee Smart Plug

Instructions for pairing with SmartThings Hub

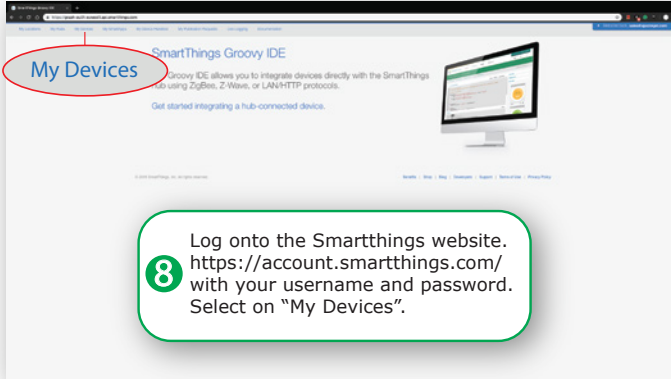

8 Log onto the Smartthings website. <https://account.smartthings.com/> with your username and password. Select on "My Devices".

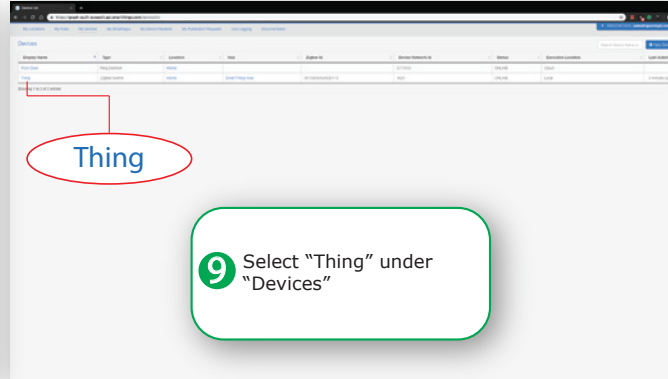

9 Select "Thing" under "Devices"

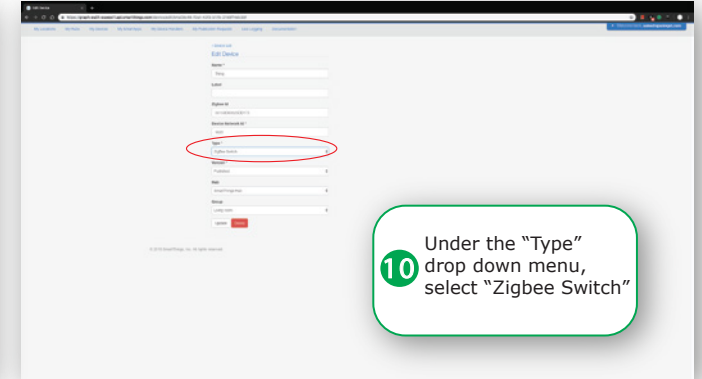

10 Under the "Type" drop down menu, select "Zigbee Switch"

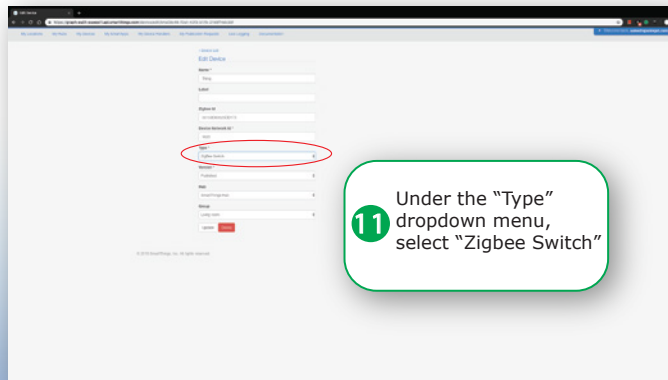

11 Under the "Type" dropdown menu, select "Zigbee Switch"

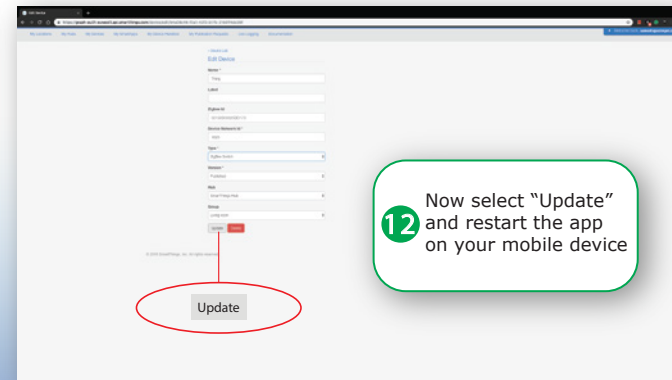

12 Now select "Update" and restart the app on your mobile device