

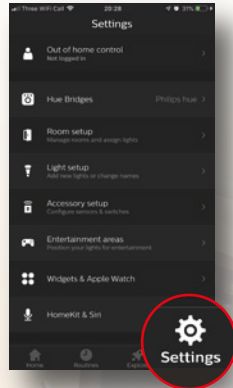

## Zigbee Lights Instructions for pairing with Philips Hue Bridge

**1** Open the Hue App and press Settings.



**2** Select Light setup and select "Add Lights"

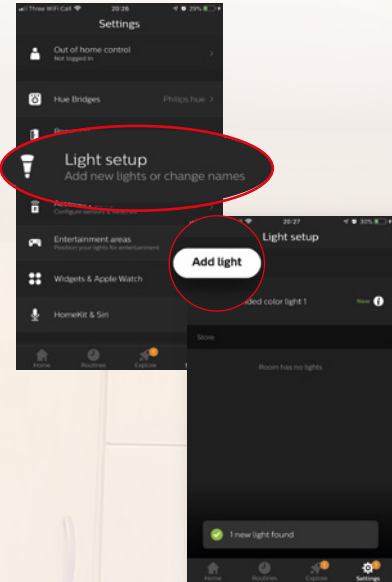

**3** Select "Search". The new light will show as "Extended colour light"

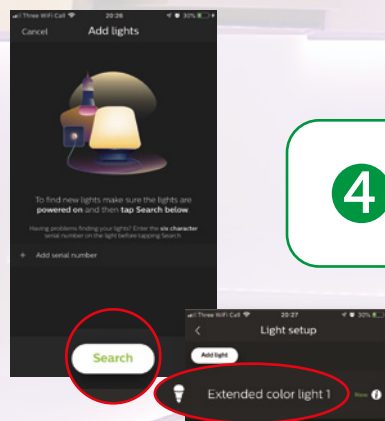

**4** Add to room via room setup

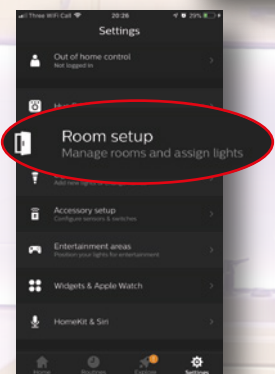

**5** Now create a room or add the newly discovered light to existing room\*

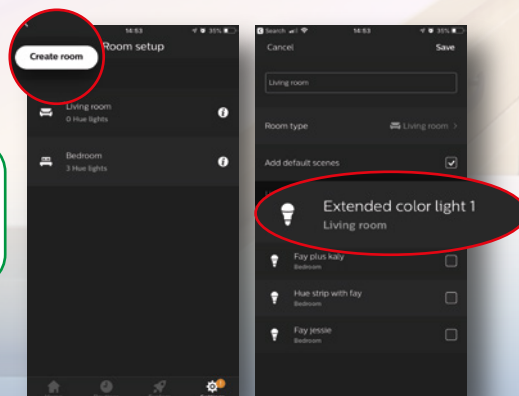

\*If this fails, reset the controller by switching it on and off 5 times from the mains. Led strip will blink and glow softly. Repeat steps 1-5.

For further information, please contact us and we'll be happy to assist you.

## Instructions for connecting LED Strip Kit

**LED Strip**



**LED Controller**



**DC Adapter**



**LED Strip**

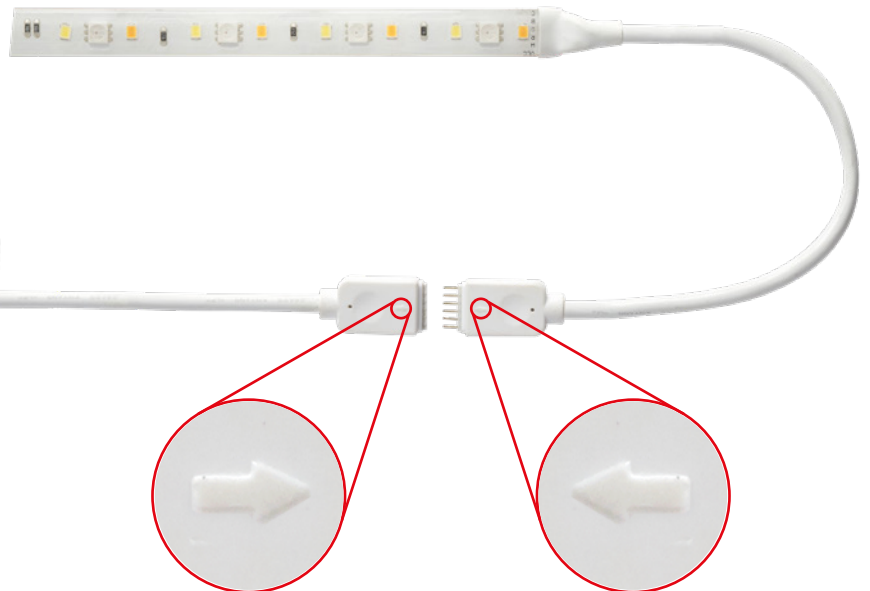

**LED Controller**



**DC Adapter**

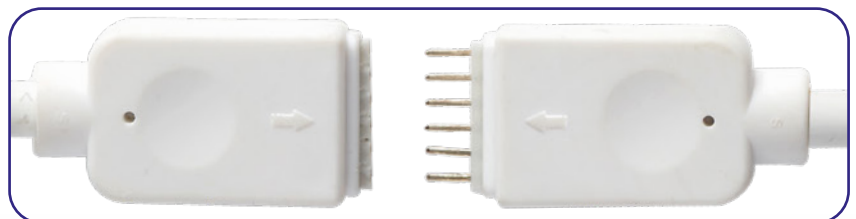

Connect the DC adapter to the LED Controller.

When connecting the LED Strip and LED Controller, ensure that the arrows align before connecting

For further information, please contact us and we'll be happy to assist you.