

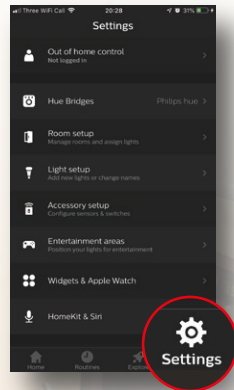

Zigbee Lights

Instructions for pairing with Philips Hue Bridge

1 Open the Hue App and press Settings.



2 Select Light setup and select "Add Lights"

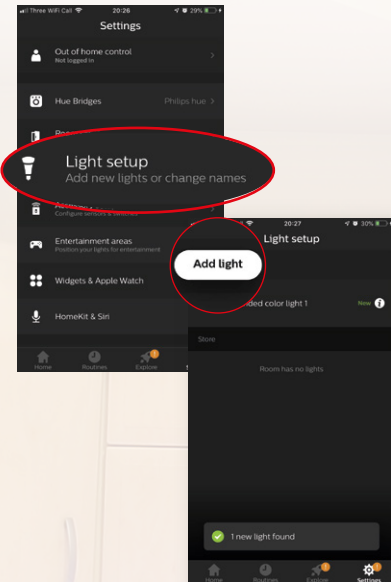

3 Select "Search". The new light will show as "Extended colour light 1" and "Dimmable light 1"

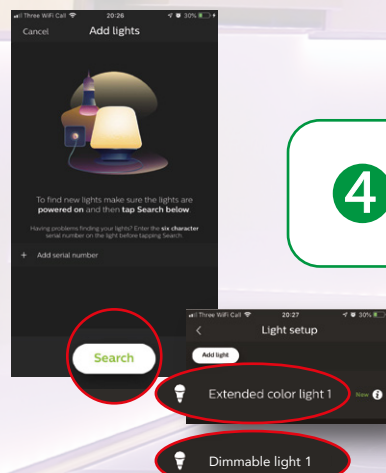

4 Add to room via room setup

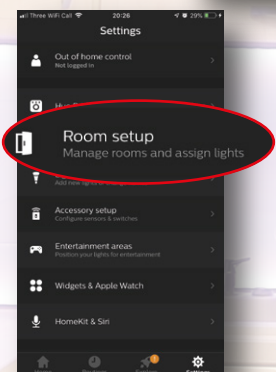

5 Now create a room or add the newly discovered light to existing room*

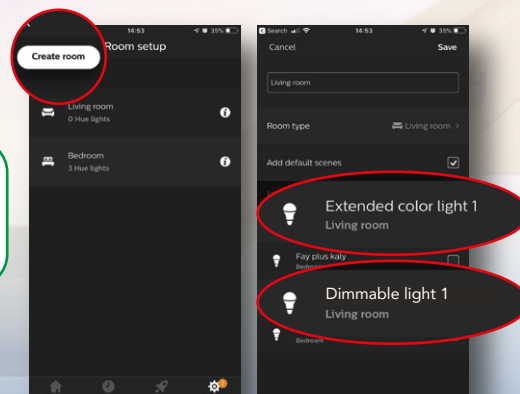

*If this fails, reset the controller by switching it on and off 5 times. Led strip will blink and glow softly. Repeat steps 1-5.

For further information, please contact us and we'll be happy to assist you.

Options

1 RGBW Led Strip.

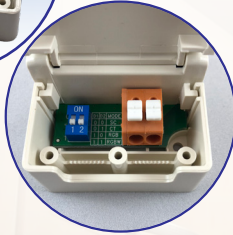
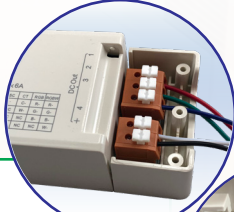

2 RGB LED Strip.

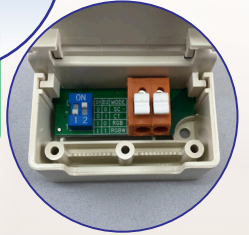
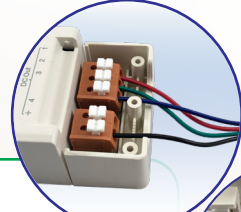

3 CCT white
colours LED strip

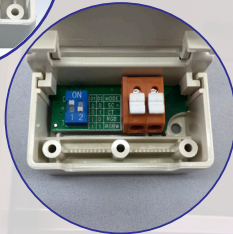
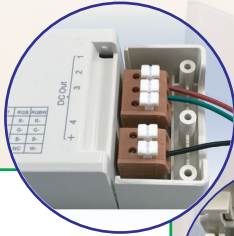

4 Single
Colours LED strip

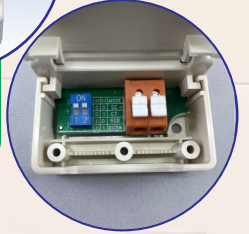
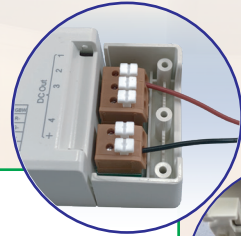

Instructions

1 Use a small flat head screw driver and Push Down on the white button.

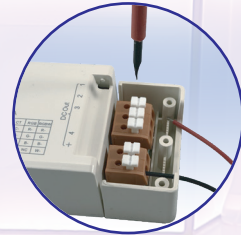

2 Keep it pushed down and insert the wire.

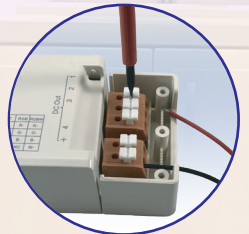

3 Release the screw driver. Tug gently on the wire to make sure the wire is secured.

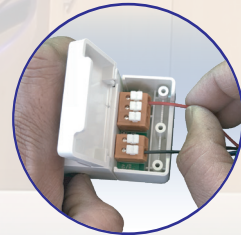

4 Finally screw in the wire clip.

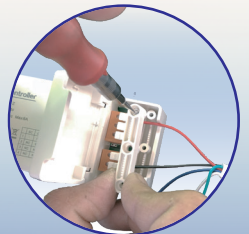

For further information, please contact us and we'll be happy to assist you.